

---

# Classic pillar cleat in bronze



## Product attributes:

Size: 63 mm, 100 mm, 125 mm, 150 mm, 200 mm, 250 mm

## Product codes:

Reference: 1084/BR/XX  
EAN13: -  
UPC: -

## Product features:

Composition: Bronze  
Manufacture: England

## Product short description:

The classic solid bronze pillar cleat is perfect for maintain your mooring lines on the deck or the halyards on the mast of your boat.

Built to be durable and tough.

Designed to resist corrosion and marine conditions, it still maintains the traditional style of your vessel.

Available in several lengths from 100mm to 250mm to meet your needs.

## Product description:

### CaractEristiCS

- Classic solid bronze cleat
- English-made deck fittings
- For classic or traditional boat
- Screws not included

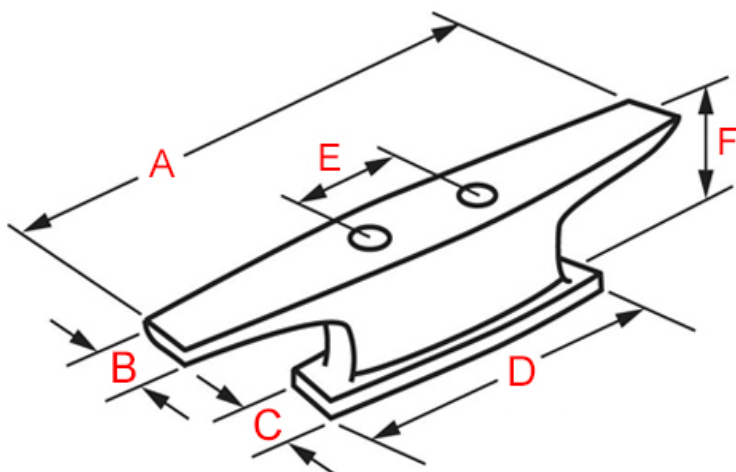

Reference	Length(A)	Cleat (B)	widthBase dimensions (cxD)	Center distance (E)	Height(F)	Screw diameter
1084/BR/063	62 mm	10 mm	12 x 34 mm	18 mm	18 mm	3.5 mm
1084/BR/100	100 mm	12 mm	22 x 56 mm	31 mm	24 mm	4.5 mm
1084/BR/125	125 mm	14 mm	26 x 68 mm	43 mm	31 mm	5 mm
1084/BR/150	150 mm	18 mm	27 x 76 mm	48 mm	37 mm	6 mm
1084/BR/200	200 mm	22 mm	35 x 90 mm	55 mm	48 mm	6 mm
1084/BR/250	250 mm	24 mm	40 x 100 mm	62 mm	65 mm	6 mm

## FREQUENTLY ASKED QUESTIONS

- 1. What screws should I order to attach this cleat?
  - To attach this cleat, you can order either bronze wood screws or bronze machine screws with matching nut and washer.

Be careful, bronze + brass + wood do not mix well outdoors. We therefore advise you to stick with bronze screws, or stainless steel if necessary.

- 2. Is this cleat available in other finishes?
  - This classic bronze cleat can be made in chrome, to order, within approximately 3 to 4 weeks.

- 
- 3. Does this cleat exist in other dimensions?

- This cleat does not exist in other dimensions and cannot be made to measure.

## **to know**

This cleat is shaped manually using century-old molds, which may cause variations in the bronze. This gives the piece a uniqueness and authenticity.

Solid bronze offers unwavering resistance to all climatic conditions, thus preserving the quality and integrity of the material.

## **Product gallery:**